

Installation Instruction

LIGHT & GREENLLC

LG-9021, LG-9022, LG-9023

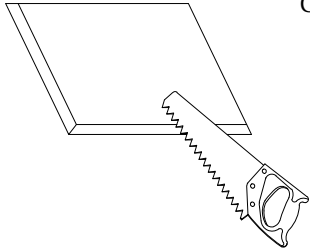

Cut out size:
LG-9021: 8.50"x 8.50"
LG-9022: 12.50"x 8.50"
LG-9023: 16.40"x 8.50"

① Cut out a hole with proper size in the ceiling.

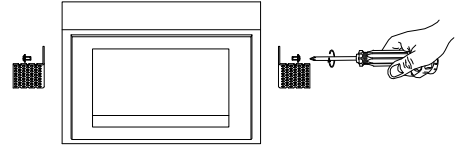

② Fix mesh holders to the plaster.

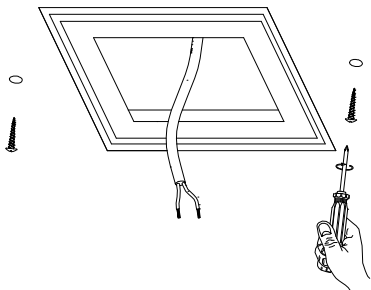

③ Fix plaster to the ceiling by crews.

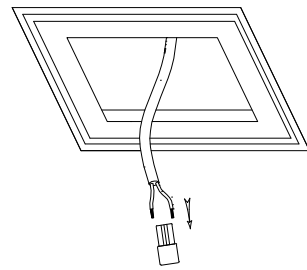

④ Connect the lead wire to connector.

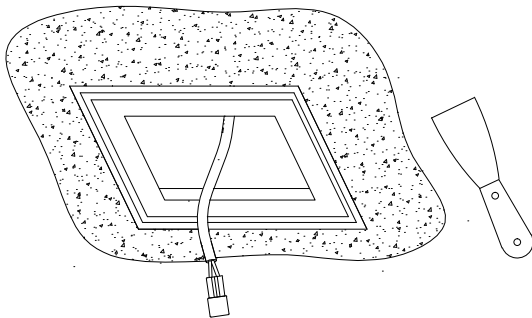

⑤ Fill up gap between ceiling and plaster body.

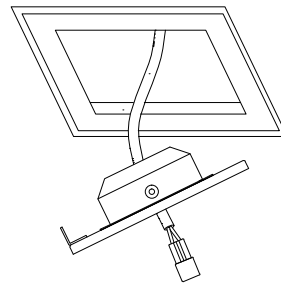

⑥ Put the metal part on the plaster.

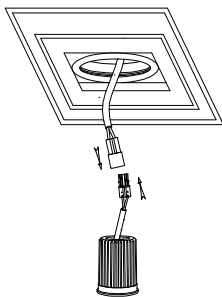

⑦ Join the connector.

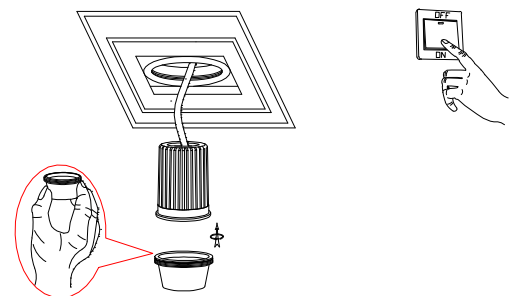

⑧ Fix the LED lamp via the metal cone, and turn on the power.